

witt

Salad Maker

WSM150



EN: 0-10

Table of contents

What the symbols mean	1
Safety instructions	1
Included components and overview of the device	4
The Device	4
Accessories	5
Unpacking	5
Cleaning	5
How to use	6
attach/remove socket for grating/cutting plate	7
attach/remove grating/cutting plate	7
Using the device	8
Cleaning and storage	8
Troubleshooting	9
Technical specifications	9
Disposing of the device	9
Warranty and Service	10



Please read the instructions before using the device and save them so you can refer to them if you have questions later. If

the device is given or sold to someone else, please ensure that you also pass along the instructions to the new owner. The manufacturer and importer are not liable if the instructions are not followed.

What the symbols mean



All safety instructions have this symbol. Please read the instructions before you start using the device. This is for your own protection and it also helps you to avoid damaging the device or sustaining personal injuries.



This symbol is for tips and recommendations. Well-suited for use with food.



Safety instructions



Intended uses

- The device is intended to be used to finely cut, chop and grate fruits, vegetables, nuts, chocolate and hard cheeses.
- This device is not suitable for cutting very hard ingredients (such as coffee beans or grains).
- This device is not a grinder! The device is not suited for cutting meat.
- This device is only intended for household use - *not* commercial use.
- This device may only be used as described in the instructions. All other uses are considered to be unsuitable.



Avoid damage or injuries

- Make sure to keep the device and packaging out of reach of children or pets. They may get injured or even choke!
- This device is not to be used by individuals (including children) with physical, sensory or mental impairments or those with lack of knowledge or experience unless they have been advised and instructed on how to use the device safely and if they understand the dangers involved. Make sure that children do not play with the device.
- Keep your head, hands, hair, jewellery and clothing away from the device's rotating parts.
- Do not reach into the filling tube with your fingers and do not use other tools to do so. Always use the included 'pusher' to put the food further down.
- The grating/cutting plates are sharp! Be careful when replacing them. Turn off the device before removing or adding the grating/cutting plates - and only touch the plastic parts when removing or adding new plates.
- Keep the device out of reach of children! You must keep an eye on children when the device is used near them.
- Do not use the device if it is damaged in any way.



Specific health and safety instructions

- There may be leftover pieces of food in the device. To protect your health, clean the device thoroughly before using it (see 'Cleaning and storage').
- Never use food that has spoiled or become rotten. Never store food past its expiration date.
- Clean the device each time after using it to prevent bacteria from forming (see 'Cleaning and storage').



Be careful of electric shocks and fires

- Do not use the device if there are flammable gases in the air.
- The device should only be attached to a correctly installed socket with grounding. The socket should also be easily accessible after connecting the device to it. The voltage must match the technical specifications of the device (see 'Technical specifications'). Only use extension cords if the technical data matches the device's specifications.
- Never place the device in a position where it might get squeezed or bent and keep it away from warm surfaces.

- Remove the plug from the socket:
 - before inserting or removing the grating/cutting plates
 - if you are not going to be using the device for a long time
 - before a thunderstorm
 - before cleaning the device.
- Make sure to pull the plug itself and not the wire when removing the plug from the socket.
- Never lower the device into water or other forms of fluid. Ensure that neither the device, cord or plug come into contact with water or moisture. If the device is dropped into water, immediately turn off the power. Do not remove the device from the water while it is still plugged in!
- Never touch the device, cord or plug with wet hands.
- Never cover the device with cloth, etc. It may overheat!
- The device may not be placed on or near hot gas stoves, cooking plates, ovens or other sources of heat.



Please note

- Do not use the device if the cord, plug or device are damaged in any way. Also do not use the device if it has been dropped in water or is not working correctly.
- Do not attempt to repair the device yourself. Damage must immediately be reported to the store where you bought the device.
 - The device is not designed for outdoors use.
- Place the device on a dry even surface that does not build up heat and ensure there is proper distance between the device and things such as walls, curtains, clothes or other materials that are sensitive to heat.
- Make sure that others cannot accidentally stumble on the cord of the device. Ensure that the power cord is not hanging out from the edge of the table or touching hot surfaces.
 - Never pull or lift the device using the power cord.
 - Never place utensils such as spoons, knives, etc. in the filling tube or in the device's rotating parts while it is in use.
 - The device is not intended to be used without breaks. Never operate the device for more than two minutes without taking a break.
 - Never use the device when it is empty.
 - If the device malfunctions or becomes damaged, immediately turn it off.

- Do not let the device run unsupervised.
- Only use original components for the device.
- Do not drop or forcefully push the device.
- Do not expose the device to temperatures that fluctuate too much, high temperatures or direct sunlight.

Warranty conditions

The manufacturer/distributor cannot be held liable for damage to products or individuals if the safety instructions were not followed. The warranty does not apply if the instructions are not followed, including if the device has been used incorrectly or damaged following unauthorised attempts at repairs.

Included components and overview of the device

The device



1. Pusher
2. Filling tube
3. On/off
4. Motor unit
5. Socket for grating/cutting plates
6. Clamping bolt

Not shown:

- Locking feature for grating/cutting plates



Accessories

Grating/cutting plate to cut thin, soft slices. This attachment can be used to cut things such as carrots, courgettes, potatoes, cucumbers, peppers, onions, apples or hard cheeses.



Grating/cutting plate for cutting thick, wavy slices. This attachment can be used to cut things such as carrots, courgettes, potatoes, cucumbers, peppers, onions, apples or hard cheeses.



This attachment is suitable for rough grating of things such as carrots, potatoes, peppers, hard cheeses (parmesan, etc.) or chocolate.



This attachment is suitable for fine grating of things as carrots, courgettes, hard cheeses (parmesan, etc.), chocolate or coconut.



This attachment is suitable for grating things such as hard cheeses (parmesan, etc.), chocolate, dry bread, puff pastry/butter dough, hazel nuts, walnuts, almonds or coconuts.

Before you use the device

Before using the device:

- unpack all components,
- clean the device.

Unpacking



BE CAREFUL!

Keep children and animals away from the packaging. They can choke on it!

Unpack the device and confirm that all components are there (see 'Included components and overview of the device'). If the device or some of the accessories are damaged, do not use the device (!) - contact a service centre.

Cleaning

There may be leftover pieces of food in the device. To protect your health, clean the device thoroughly before using it (see 'Cleaning and storage').

How to use



BE CAREFUL!

- Keep the device out of reach of children!
- Only use the device once it has been correctly assembled!
- Do not reach into the filling tube or the rotating parts while using the device.
- Keep your head, hands, hair, jewellery and clothing away from the device's rotating parts.

- The grating/cutting plates are sharp! Be careful when replacing them. Turn off the device before removing or attaching the grating/cutting plates - and only touch the plastic parts when removing or attaching new plates.

- Turn off the device and unplug it before removing the socket for grating/cutting plates or removing/changing grating/cutting plates - this prevents the device from accidentally turning on.

- Never operate the device for more than two minutes without taking a break!
- Do not force food down the filling tube!



To get the best results, we recommend that you cut the food into smaller pieces before putting them in the filling tube. This makes it easier to push the food down with the pusher.

Attach/remove the socket for grating/cutting plates.

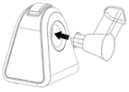

1. Tip the socket slightly to the right and place it in the motor unit.



2. Rotate the socket a quarter turn to the left until it clicks into place.



3. To remove the socket from the axle, rotate the socket a quarter turn to the right and remove it from the motor unit.

Attach/remove grating/cutting plates

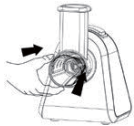

1. Select an appropriate attachment (see 'Included components and overview of the device').

2. Place the attachment into the socket holder. Ensure that the attachment is properly attached to the axle.

3. Place the locking mechanism on the axle. Ensure that the clamping bolt is properly attached to the locking mechanism.



4. Turn the locking mechanism to the left to lock the attachment into the socket.



5. To remove the attachment, turn the locking mechanism to the right to loosen it.

6. Remove the locking mechanism.



7. Remove the attachment.

Using the device

1. Place the device on an even surface.
2. Plug the device into a power source.
3. Place a bowl under the socket so that food can go into it.



4. Turn on the device by pressing down the On/Off button. Lightly press the On/Off button a few times before putting food in the filling tube so that the attachment clicks into place on the motor unit's axle.

5. Now press down on the On/Off button and add food to the filling tube. 6. Use the pusher to push food further down.

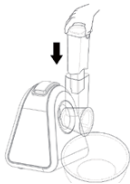

7. Press the On/Off button to turn off the device. 8.

Unplug the device after using it.

9. Remove the attachment after using it.

10. Clean the device and accessories after you have used them. See 'Cleaning and storage'.

Cleaning and storage

BE CAREFUL!

- Unplug the device before cleaning it.
- Never lower the motor unit into water or other forms of fluid.
- Be careful when handling the attachments - the grating/cutting plates are sharp.
- Do not use strong cleaning agents as they can scratch the surface.
- Clean the motor unit with a damp rag. Then dry it thoroughly with a dry rag.
- Clean the socket, the attachments and the pusher in warm water with a bit of dishwashing fluid or put them in the dishwasher.
- Store the device in a dry place that is not accessible to children or animals.

Troubleshooting

If the device is not working properly, first try to see if you can fix the issue yourself. If you cannot, then contact the store from which you purchased the device. Do not attempt to repair the device yourself!

Problem	Possible cause/solution
The device is not working	<ul style="list-style-type: none">• Is the device correctly plugged in to the socket?• Is the socket broken? Try to attach the device to another socket.• Check your electrical fuses.• Are you holding down the On/Off button? To turn on the device, you need to hold down the On/Off button for a little while.

Technical specifications

Model: VC05

Voltage: 220 – 240 V~ 50/60

Hz Output: 150 W

Protection class: II

Disposing of the device



The packaging can be recycled. Please dispose of it in an environmentally friendly manner and take it to a recycling station.



The symbol means that the product should not be thrown out together with regular household waste. Instead, it should be disposed of at an authorised recycling station which is suitable for this purpose or returned to a retailer that offers disposal services. Contact your local city council if you need more information.

WARRANTY AND SERVICE

There is a 2-year warranty period if your new product stops working due to manufacturing or material faults which begins from the documented date of purchase. The warranty covers materials and the cost of labour. When inquiring about service, please state the product name and serial number. You can find this information on the type plate. You can write down the information here in these instructions so that you have them at hand. This makes it easier for the service technician to find the correct spare parts.

The warranty does not cover:

- Faults and damage that are not due to manufacturing or material issues
- Damage caused by failure to properly maintain the device - including failing to clean it
- Fire and/or water damage or moisture damage on the product
- Damage caused during transport if the product was transported without proper packaging
- Damage caused by the use of unoriginal spare parts
- Damage resulting from failing to follow the instructions on how to use the device
- If the device has not been set up/assembled as specified in the instructions
- If non-professionals have installed or repaired the product
- Batteries or any other parts subject to normal wear and tear

Damage during transport

If the product is damaged during transport and this is discovered when the retailer delivers the product to the customer, this is exclusively a matter between the customer and the retailer. In cases where customers have handled the transport of the product themselves, the supplier shall not be liable for any potential damage during transport. Any damage caused during transport must be reported immediately and no later than 24 hours after the product has been delivered. If not, the customer's claim will be rejected.

Unnecessary service

If the product is sent in to be serviced and it turns out that the fault could have been fixed independently by following the product's instruction manual, the customer will need to pay the service fee.

Commercial purchases

Commercial purchases are all purchases of devices that are not intended to be used in private households but instead intended to be used for commercial purposes (in restaurants, cafés, canteens, etc.) or intended to be rented out or otherwise used by multiple users in turn.

There is no warranty offered for commercial purchases, as this product is only intended for regular household use.

Service

For service and spare parts in England and Ireland please call below-mentioned number and you will be directed accordingly or send us an email.

Witt UK & Ireland Ltd.

(44) 148 351 6633 / info@witt.dk

We accept no liability for printing errors.

The manufacturer/distributor cannot be held liable for damage to products or individuals if the safety instructions were not followed. The warranty shall not cover cases where the instructions have not been followed.

